

WORX®

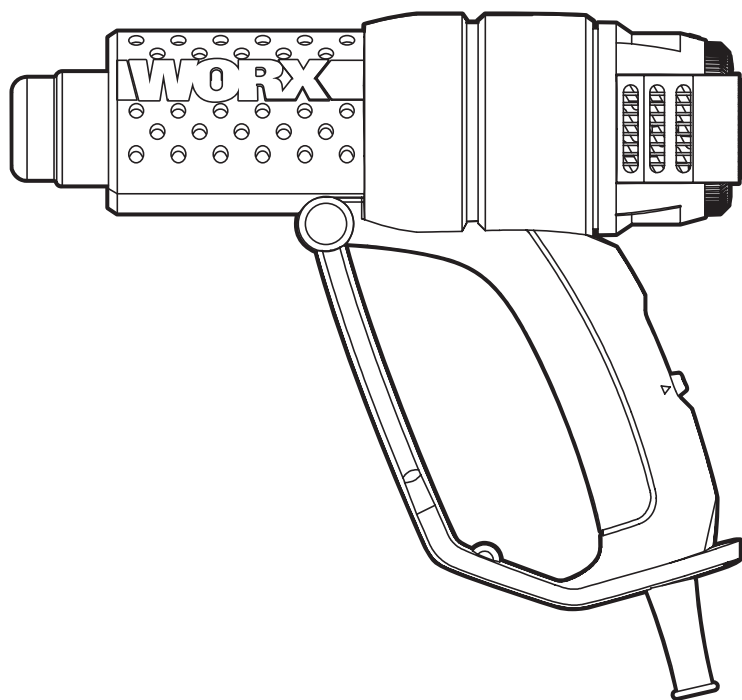

Heat gun	EN	P04
Тепловой пистолет	RU	P10
Kuumapüstol	ET	P15
Karstā gaisa pistole	LV	P20
Džiovintuvas	LT	P25

WX041

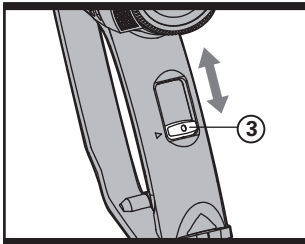
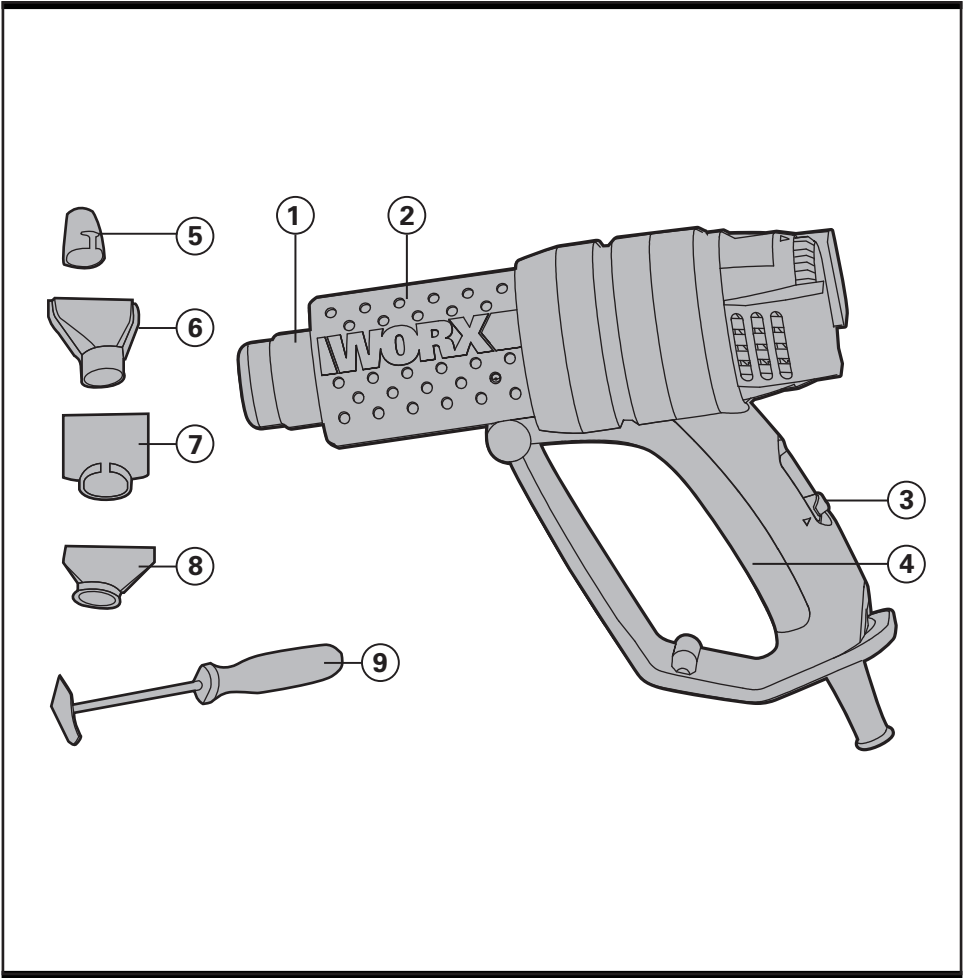

A

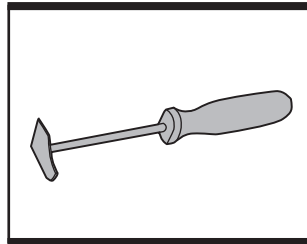

B

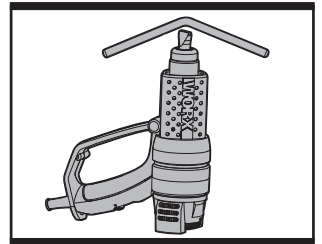

C

- 1. NOZZLE**
- 2. HEAT PROTECTION**
- 3. ON-OFF SWITCH/SELECTOR SWITCH**
- 4. RUBBER OVERMOULD GRIP**
- 5. REDUCTION NOZZLE ***
- 6. WIDE NOZZLE ***
- 7. REFLECTOR NOZZLE ***
- 8. GLASS PROTECTION NOZZLE ***
- 9. SCRAPER ***

***Not all the accessories illustrated or described are included in standard delivery.**

TECHNICAL DATA

Voltage	230-240V~50Hz
Power input	2000W
Temperature/Airflow control	I =50°C/300L/min
	II =350°C/300L/min
	III = 580°C/500L/min
Machine weight	0.8kg
Protection class	 / II

ACCESSORIES

Scraper	1
Glass protection nozzle	1
Reduction nozzle	1
Reflector nozzle	1
Wide nozzle	1

We recommend that you purchase your accessories from the same store that sold you the tool. Use good quality accessories marked with a well-known brand name. Choose the type according to the work you intend to undertake. Refer to the accessory packaging for further details. Store personnel can assist you and offer advice.

GENERAL SAFETY WARNINGS



WARNING! Read all safety warnings and all instructions. Failure to follow the warnings and instructions may result in electric shock, fire and/or serious injury.

Save all warnings and instructions for future reference.

This appliance can be used by children aged from 8 years and above and persons with reduced physical, sensory or mental capabilities or lack of experience and knowledge if they have been given supervision or instruction concerning use of the appliance in a safe way and understand the hazards involved. Children shall not play with the appliance. Cleaning and user maintenance shall not be made by children without supervision.

If the supply cord is damaged, it must be replaced by the manufacturer, its service agent or similarly qualified persons in order to avoid a hazard.

ADDITIONAL SAFETY INSTRUCTIONS FOR YOUR HEAT GUN

1. A fire may result if the appliance is not used with care, therefore
 - Be careful when using the appliance in place where there

are combustible materials or gases, extreme caution must be taken to prevent fire or explosion.;

- Do not apply to the same place for a long time;
- Do not use in presence of an explosive atmosphere;
- Be aware that heat may be conducted to combustible materials that are out of sight;
- Place the appliance on its stand after use and allow it to cool down before storage;
- Do not leave the appliance unattended when it is switched on.

- 2. Always place the appliance on its stand after use and allow it to cool down before storage** and never touch the heat deflector.

SYMBOLS



To reduce the risk of injury, user must read instruction manual



Warning



Double insulation



Wear eye protection



Wear ear protection



Wear dust mask

Waste electrical products should not be disposed of with household waste. Please recycle where facilities exist. Check with your Local Authority or retailer for recycling advice.



OPERATION



NOTE: Before using the tool, read the instruction book carefully.

INTENDED USE

The unit is intended for the forming and welding of plastic, removal of paint and the warming of heat shrinkable tubing. It is also suitable for soldering and tinning, loosening of adhesive joints and the defrosting of water lines.

PUTTING INTO OPERATION

1. SWITCHING ON/OFF (Fig A)

Switching on:

To put into operation, slide the switch (3) to position **I**, **II** or **III**.

Switching off:

To switch off, slide the on/off switch (3) to the stop at position **0**.

After working for a longer time with high temperature, allow the unit to cool by running in the cold air setting **I** before switching off.

2. THERMO-PROTECTION SWITCH-OFF

When the heater is overloaded (e.g. as a result of restricted air flow), the unit switches it off automatically, however, the blower continues to run. When the unit has cooled to operating temperature, the heater is switched on again.

3. SETTING THE AIR FLOW AND TEMPERATURE

The switch (3) can be set to three blower steps. Suitable air flow and temperature combinations can be selected according to the applications.

WX041

Step	temperature	Airflow
I	50°C	300L/min
II	350°C	300L/min
III	580°C	500L/min

The cold air setting **I** is suitable for cooling a warmed work piece or for the drying of paint. It is also suitable for cooling the unit before

placing down or the changing of nozzles. The air setting **II** is suitable for Bending Plastic and heating shrinking plastic. The air setting **III** is suitable for stripping paint and defrosting pipes.

4. WORKING EXAMPLES

Temperature settings given in the application examples are suggested values that, depending on the material characteristics, can deviate. The distance between the nozzle and work piece is dependent on the material to be processed.

The ideal temperature should first be ascertained by performing a test. Therefore, begin with a lower temperature setting. All application examples (except **Removing Paint from Window Frames**) can be performed without accessories. However, the use of the recommended accessory part simplifies the work and significantly improves the quality of the results.

- Be careful when changing the nozzle, danger of burning! Do not touch the hot nozzle. Allow the unit to cool. Wear protective gloves.

5. SCRAPER (Fig B)

The scraper is ideal for stripping paint from flat wooden surface and edges. Remember to clean the blade after use with wire wool and lightly oil before storing.

6. REMOVING PAINT

Choose the required nozzle and fit onto the heat outlet. Soften the paint using hot air and remove evenly using a spatula. Do not heat the paint for too long since this will burn the paint, making it more difficult to remove.

7. REMOVING PAINT FROM WINDOW FRAMES

Danger of glass breaking!

Use of the glass protection nozzle is essential. On profiled surfaces, paint can be removed using a spatula and brushed off using a soft wire brush.

8. DEFROSTING FROZEN PIPES Water lines often do not differ in

appearance from gas lines. Gas lines are not to be heated under any circumstances.

Place on the reflector nozzle. Heat the frozen zone always from the outside to the middle. Warm plastic pipes as well as connections between pipe pieces especially carefully to prevent damage.

9. SHRINK SEATING ELECTRICAL CABLES

Place on the reduction nozzle. Select the diameter of the heat-shrink tubing according to the work piece, for example, a cable lug. Heat the heat-shrinkable sleeve evenly. Many adhesives (e.g. stickers) become softer when heated allowing adhesive bonds to be separated or superfluous adhesive to be removed.

10. WELDING PLASTICS

Place on the reduction nozzle and the welding shoe. The materials to be welded and the welding rod must be made of the same material (e.g. PVC with PVC). The seam must be clean and grease-free. Heat the welding seam until it becomes tacky. Please note that the temperature difference between the tacky and liquid state of a plastic is very small. Then feed in the welding rod and allow to run into the gap so that a uniform bead is produced.

11. BENDING PLASTIC TUBE (Fig C)

Choose the hook nozzle and fit over heat outlet. Turn the gun upside down and place on its clip stand so that it is resting on a secure bench with the nozzle pointing upwards, see picture. To avoid buckling or kinking the tube, fill the tube with dry sand and seal at both ends. Heat the tube evenly by moving from side to side and bend to required shape.

MAINTENANCE

Remove the plug from the socket before carrying out any adjustment, servicing or maintenance.

There are no user serviceable parts in your power tool. Never use water or chemical cleaners to clean your power tool. Wipe clean

with a dry cloth. Always store your power tool in a dry place. Keep the motor ventilation slots clean. Keep all working controls free of dust. Occasionally you may see sparks through the ventilation slots. This is normal and will not damage your power tool.

If the supply cord is damaged, it must be replaced by the manufacturer, its service agent or similarly qualified persons in order to avoid a hazard.

ENVIRONMENTAL PROTECTION



Waste electrical products should not be disposed of with household waste.

■ Please recycle where facilities exist.

Check with your Local Authority or retailer for recycling advice.

PLUG REPLACEMENT (UK & IRELAND ONLY)

If you need to replace the fitted plug then follow the instructions below.

IMPORTANT

The wires in the mains lead are colored in accordance with the following code:

Blue = Neutral

Brown = Live

As the colors of the wires in the mains lead of this appliance may not correspond with the coloured markings identifying the terminals in your plug, proceed as follows. The wire which is coloured

blue must be connected to the terminal which is marked with N. The wire which is coloured brown must be connected to the terminal which is marked with L.

WARNING: Never connect live or neutral wires to the earth terminal of the plug. Only fit an approved BS1363/A plug and the correct rated fuse.

NOTE: If a moulded plug is fitted and has to be removed take great care in disposing of the plug and severed cable, it must be destroyed to prevent engaging into a socket.

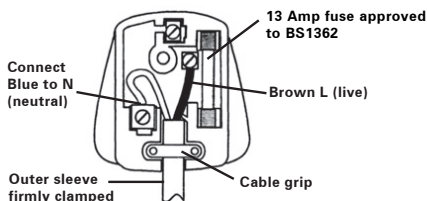

DECLARATION OF CONFORMITY

We,
POSITEC Germany GmbH
Konrad-Adenauer-Ufer 37
50668 Köln

Declare that the product
Description **Heat gun**
Type **WX041**

Complies with the following directive:

2006/95/EC
2004/108/EC
2011/65/EU

Standards conform to

EN 60335-1
EN 60335-2-45
EN 55014-1
EN 55014-2
EN 61000-3-2
EN 61000-3-3
EN 62233



Suzhou 2014/12/22
Allen Ding
Deputy Chief Engineer, Testing &
Certification

WORX
you've got the power

www.worxtools.com

Copyright © 2015, Positec. All Rights Reserved.
2SHG102PK11001A1